

ROTARY STEP ATTENUATORS

Model RSA-3511D

Features:

- Wide Frequency Range
DC to 2.5GHz
- High Accuracy Rate
- Price Competitive
- Flexible Design Configurations

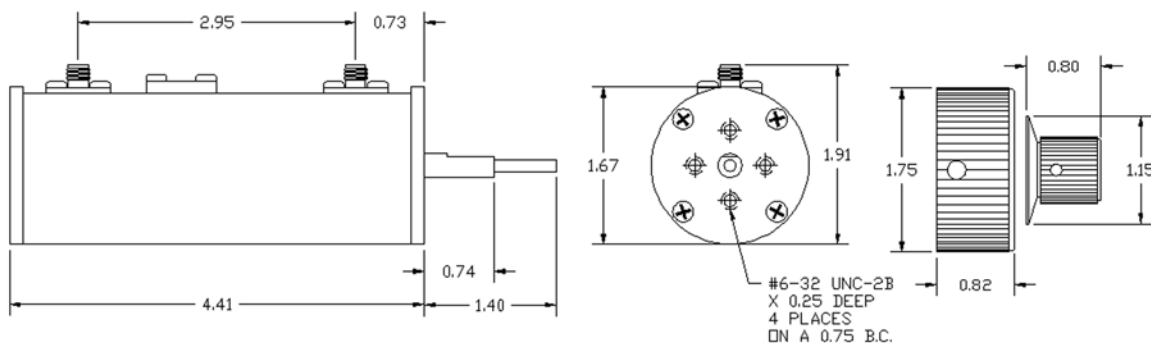

Trilithic's new state-of-the-art rotary step attenuators are designed for precision control of signal levels in the DC to 2.5 GHz range and are offered in a wide choice of values and increments. This new design allows for greater automation of assembly and unprecedented low cost. **Please contact the factory for your custom needs.**

SPECIFICATIONS

FREQUENCY RANGE	DC to 2.5 GHz	ACCURACY	
IMPEDANCE	50 Ohms	0 - 1.0 GHz	
ATTENUATION	0 - 11 dB in .1 dB	+/- 0.05 dB	0 - 1 dB (.1dB steps)
AVERAGE POWER	2 Watts (25 Degrees C)	+/- 0.20 dB	1 - 10 dB (1 dB steps)
SWITCHING LIFE	200,000 Steps Minimum	1.0 - 2.0 GHz	
ROTATION	Clockwise for increasing attenuation in 30 degree indexing	+/- 0.05 dB	0 - 1 dB (.1dB steps)
CONNECTORS	Female: SMA, BNC, TNC, N (BNC not recommended above 1 GHz)	+/- 0.30 dB	1 - 10 dB (1 dB steps)
HOUSING	Aluminum and Zinc	2.0 - 2.5 GHz	
INSERTION LOSS		+/- 0.05 dB	0 - 1 dB (.1dB steps)
		+/- 0.40 dB	1 - 10 dB (1 dB steps)
		VSWR / RETURN LOSS	
		FREQUENCY RANGE	VSWR
		0 - 1 GHz	1.3 : 1 max
		1-2.5 GHz	1.5 : 1 max

Note: Electrical & Mechanical Specifications and Dimension may change without prior notice.

Rev. 12/04



Trilithic, Inc 9710 Park Davis Drive, Indianapolis, Indiana 46235 USA
Toll Free (800) 344-2412 Phone: (317) 895-3600 Fax: (317) 895-3612
Web: www.trilithic.com Email: Sales@trilithic.com